

17374
CITY OF NAPOLEON
BUILDING CONSTRUCTION PERMIT
 (1, 2 or 3 Family Dwelling)

Owner Name Penny Rattig
East
 Address 839 Graceway Dr.
 Builder Name George H. Miankan
 Address 715 Romain St. Tel. 502-1093

Lot Information:

Street No. 839 E. Graceway Dr.
 Lot #59 Subdivision Richter's 3rd Add.
 Lot Dimensions Lot Area Sq. Ft.
 Yard Set Back: Front ---- Rear Min. 15'
One Side 5', Total Side Not Less Than 29'.7

Zoning "A" Intended use of Building: Constructing to the rear of the existing dwelling the following: 8'x8' aluminum frame patio cover, alum. cenopy over door and window.

Building Information:

Single Double Multiple New Construction Addition Remodel
 Size: Length 8' Width 8' No. of Stories 1
 Floor Area: 1st Floor 2nd Floor 3rd Floor Basement
 Unfinished Attic Garage
 Foundation: Piers Full Basement Part Basement
 Concrete Block
 Walls: Frame Block Brick Other
 Electrical: Wiring --- Electric Heating --- Electrical Appliances ---
 Plumbing: Fixtures or Traps Warm Air Heating Hot Water Heating

Additional Information: This permit requires compliance with the attached addendum marked exhibit "A" and made a part here-of.

Date Aug 5-75 Applicant Signature Geo. H. Miankan
 Owner - Builder - Agent

NOTE: PROPER GROUNDING & BONDING OF THE METAL ROOF IS REQUIRED. SEC. 926.5 OF THE BUILDING CODES. MUST CONTACT THE BUILDING INSPECTOR WHEN THE PROJECT IS COMPLETED.

Inspection Record:

Work Started	Foundations	Plumbing, Heating
Set Back, Side Lines <u>3/6</u> <u>ck'd by P.W.P.</u>	Plumbing (Rough In)	And Air Conditioning
Excavation	Erecting Frame	Roof
Footing	Electrical Work	

Comments: 3/6/75 missing grounding for roof 9/9/75 ground installed
ck'd by P.W.P.

Certificate of Occupancy Issued

Pink - Engineer

Inspector

Permit No.	<u>312-75</u>		
Issued	<u>7/29/75</u>		
By	<u>Thomas L. Brennan</u> Building Inspector		
Valuation	<u>\$500.00</u>		
	Fees	Base	Plus
Construction	<u>\$6.00</u>	<u>--</u>	<u>\$6.00</u>
Plumbing			
Electrical			
Heating			
Water Tap			
Sewer Tap			
Temporary Elec.			
TOTAL	<u>\$6.00</u>	<u>--</u>	<u>\$6.00</u>

CITY OF NAPOLEON
ENGINEERING DEPARTMENT
APPLICATION FOR CONSTRUCTION PERMIT
(PLEASE PRINT OR TYPE)

The undersigned hereby makes application for the construction, installation, replacement or alteration as herein specified, agreeing to do all such work in strict accordance with the City of Napoleon's Building Code for 1, 2 and 3 Family Buildings.

Owner's Name Perry Rettig Address 839 E. Graceway

Builder's Name Geo. H. Wiemken Address 715 Roman St Tel. 592-1093

LOT INFORMATION: (Not required for roofing or siding job.)

Location of Project _____ Lot # 59

Subdivision Richter's 3rd Add. Lot Area _____ Sq. Ft.

Yard Set Back: Front Approx 25ft Rear Approx 48' Left Side Approx 8'
Right Side Approx 15' Zoning District _____

BUILDING INFORMATION:

Single Double _____ Multiple _____ New Construction _____

Addition Remodel _____ Attached Garage _____

Detached Garage _____ Accessory Building _____ Replacement _____

Brief Description of Work: 100 7/8" x 101" Canopy over patio, 61" wide
Canopy over back door & 102" wide roll-up awning over
P.D.

Size: Length _____ Width _____ No. of Stories _____

Floor Area: 1st Floor _____ Sq. Ft. 2nd Floor _____ Sq. Ft.

3rd Floor _____ Sq. Ft. Basement _____ Sq. Ft.

Unfinished Attic _____ Garage _____

Foundation: Piers _____ Full Basement _____ Part Basement _____

Concrete _____ Thickness _____ Block _____ Size _____

Walls: Frame _____ Block _____ Brick _____ Other _____

Specific Type of Exterior Siding _____

APPLICATION FOR PERMIT SHALL BE ACCOMPANIED BY TWO COMPLETE SETS OF PLANS INCLUDING: ELEVATIONS, FLOOR PLANS, CROSS SECTIONS AND PLOT PLAN. IF ADDITIONS OR REMODELING, SHOW ALL EXISTING STRUCTURES AND THEIR SIZE AND LOCATION. ALL PLANS SHALL BE DRAWN TO 1/4"=1'-0" SCALE. PLOT PLAN DRAWN TO 1/8"=1'-0" SCALE.

ESTIMATED COST OF COMPLETED PROJECT: Geo. H. Wiemken
DATE 6-30-75 APPLICANT'S SIGNATURE _____ \$ 590.50
OWNER-BUILDER-AGENT

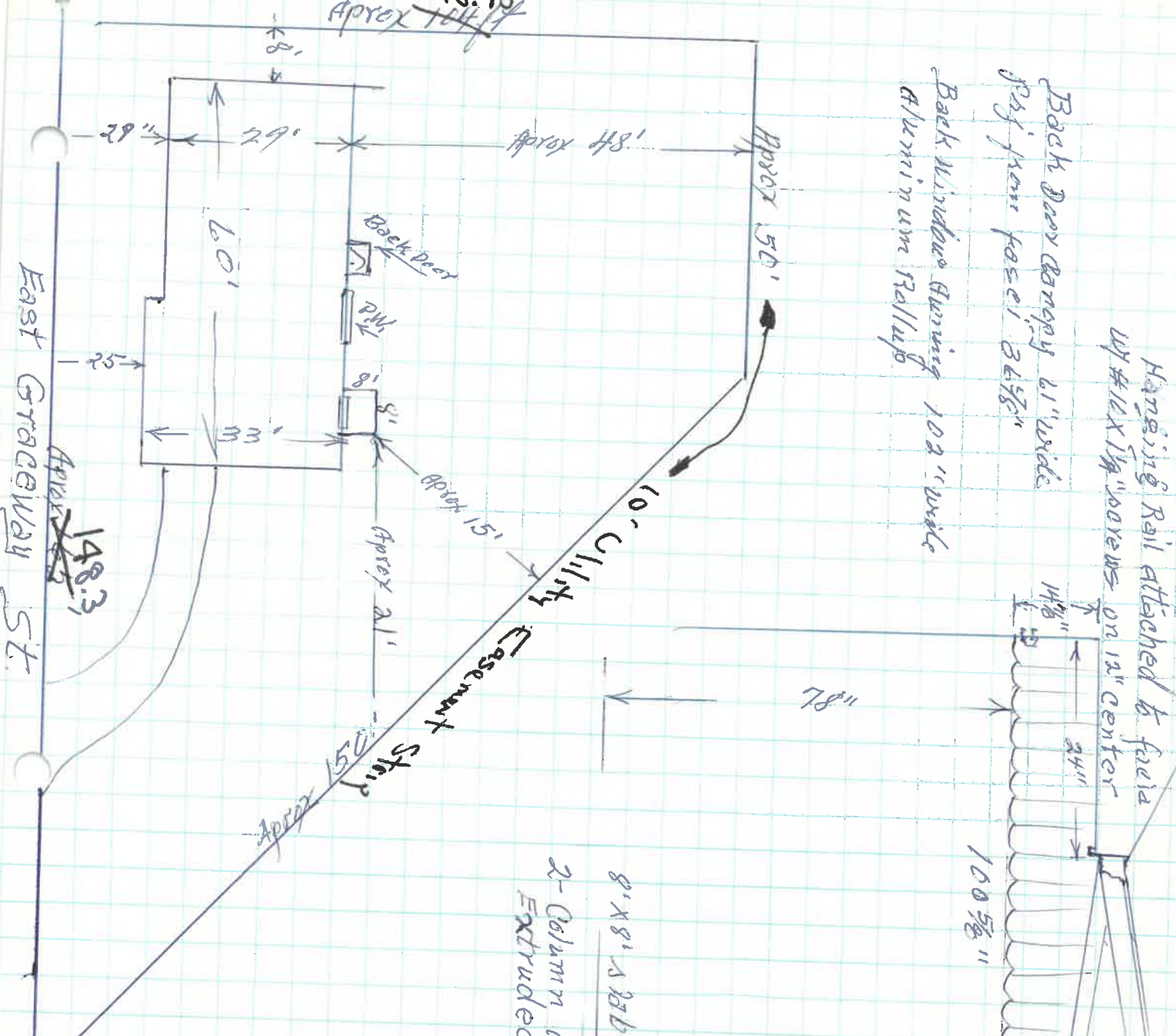

Hanging Rail attached to fascia
 w/ #16 x 1 1/4" screws on 12" center
 Back Door Canopy 61" wide
 Paj from fasci 3 1/2"
 Back Window Opening 102" wide
 Aluminum Rollup

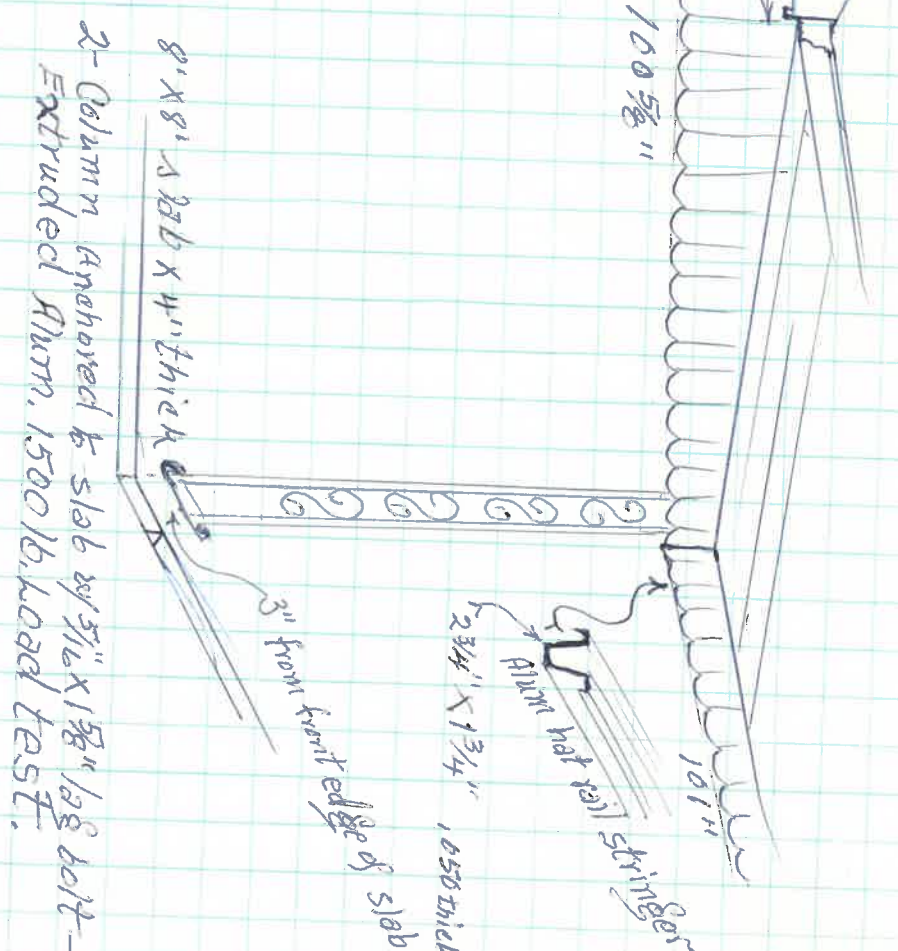

2-Column Anchored to slab by 5/16" x 1 5/8" lag bolt -
 Extruded Alum. 1500 lb. load test.

PERRY TOTTIG
 839 E. Graceway
 WIEMKEN'S
 owning, door & window service
 715 Romain Street • Napoleon, Ohio

